

OPERATING INSTRUCTIONS

Plastic Ketchup Dispenser Model No. 404-SL



TABLE OF CONTENTS	PAGE
Assembly	2
Operating	3
Cleaning	3
Troubleshooting	4
Parts List & Exploded View	4 & 5

The Prince Castle Plastic Ketchup Dispenser has a lightweight plastic shell which includes a cover with tether attachment to reduce loss. The dispenser has positive pump action which provides accurate portions everytime, plus all internal parts are colored red, providing easy identification.

SPECIFICATIONS

Height	Diameter	Shipping Wgt.
9-1/2" (24.1cm)	6-1/2" (16.5cm)	3 lbs. (1.4kg)

WARRANTY

This product is warranted to be free from defects in material and/or workmanship for a period of one year from the date of original installation. Any component which proves to be faulty during the warranty period will be replaced without cost to the customer.

ASSEMBLY

1. After you have removed the dispenser from the carton, inspect the unit for signs of damage. If there is damage to the unit:
 - Notify carrier within 24 hours after delivery.
 - Save carton and packing materials for inspection purposes.
 - Contact your Prince Castle Dealer for replacement or the the Prince Castle Customer Sales Department at 1-800-722-7853 if purchased directly.
2. Verify that all parts have been received.
3. Wash all parts before using.
4. Place dispenser in Prep Pan.

IMPORTANT: Before filling dispenser, shake ketchup container vigorously. Be sure lid on ketchup gallon is tightly sealed.

5. Assemble all internal parts of the spring assembly. See figure 1.

figure 1

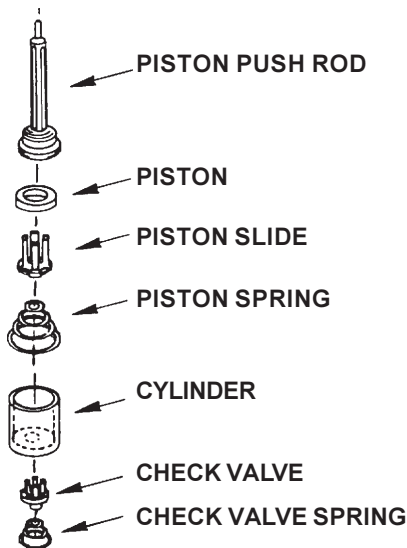

6. Place assembled internal parts into dispenser container. See figure 2.

figure 2

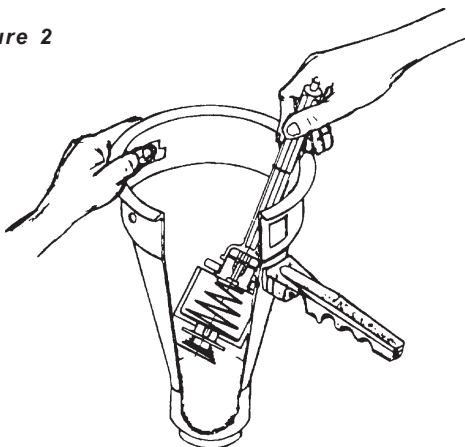

7. Place adjusting cam on top of piston push rod so push rod enters hole #3 in adjusting cam. See figure 3.

IMPORTANT: Make sure that the arrow located on the side of the adjusting cam points to the handle of the dispenser and numbers are facing up.

figure 3

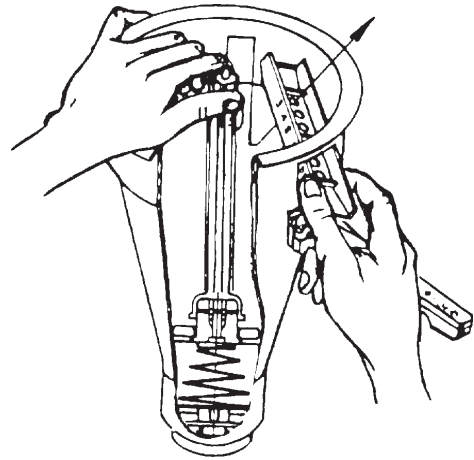

8. Attach lever with rounded corners facing down towards the adjusting cam. See figure 4.
 - a. Slide the lever through the hole in the container located above the handle of the dispenser.
 - b. Continue to slide the lever forward until the push rod falls into the hole located in the lever.
 - c. Continue pressing adjusting cam and push rod while sliding the lever forward until the front end enters the "T"-shaped hole on the other side of the container.

figure 4

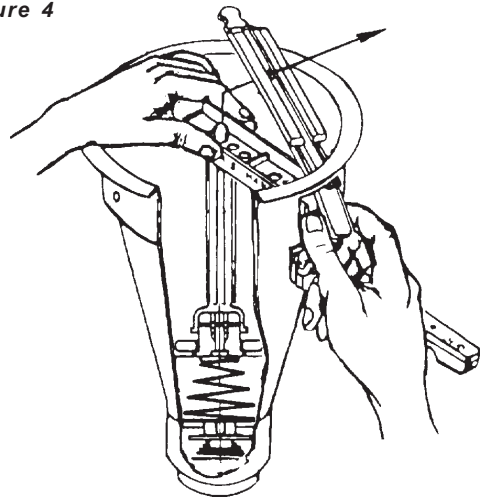

9. Dispenser is now fully assembled. Pour ketchup into the container up to the Fill Line. Place the lid on top of the container before using the dispenser. See figure 5.

figure 5

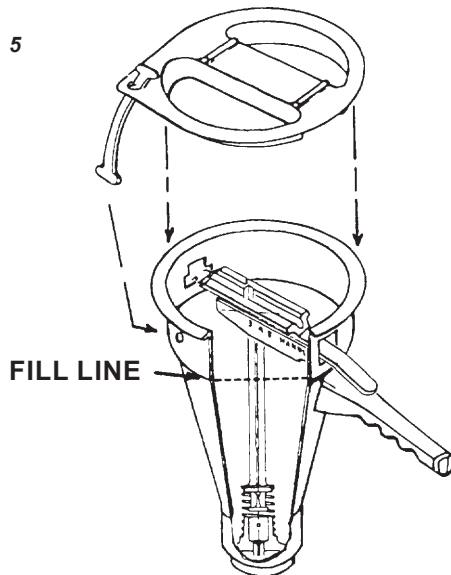

OPERATION

1. The ketchup dispenser **must** be primed before using.
2. Press down on the lever several times (approximately 10 to completely prime).
3. Wipe the bottom of the dispenser with a clean, moist hand towel after priming.

Calibration

Set Brix cup under dispenser and dispense 6 shots of ketchup into cup. Allow the lever to return fully after each shot. 6 shots will dispense 2 fl.oz. (60 ml) of ketchup for regulars and 3 fl.oz. (90 ml) for quarters. If the amount of ketchup dispensed into the cup is above or below the ounces required, move adjusting cam from hole #3 to hole #2 to DECREASE volume, or move to hole #4 to INCREASE the amount of ketchup dispensed. Repeat this adjustment until dispenser is properly calibrated.

IMPORTANT: The lower numbered holes dispense less ketchup. The higher numbered holes provide more ketchup. For all hole number settings, the arrow mark on the side of the adjusting cam must always point towards the handle of dispenser.

CLEANING

1. Empty ketchup from dispenser and discard.
2. Fill dispenser with warm water. Repeatedly press actuating lever to pump water and flush out dispenser.
3. Remove internal parts from container by pushing down the lever and the push rod. Slide the lever out of the "T" shaped hole in the container. Remove the adjusting cam.
4. Lift the push rod and spring assembly straight up and out of the container.
5. Separate all internal parts to thoroughly clean. Wash the container and all loose internal parts in a solution of warm water and McDonald's All Purpose Concentrate (APC) (HCS).
6. Rinse all loose parts and the container with running water.
7. Sanitize dispenser (use 1 packet of McDonald's Sanitizer (HCS) to a 2-1/2 gallons (8.5 l) of warm water).
8. Let air dry.

IMPORTANT: Do not reassemble ketchup dispenser until it is ready to be used the next day.

TROUBLESHOOTING CHART

PROBLEM	PROBABLE CAUSE	CORRECTIVE ACTION
Will not dispense.	Plastic parts broken.	Replace broken parts.
	Not assembled properly.	Assemble properly.
	Not primed.	See set-up procedure.
	Parts missing.	Check for proper assembly and placement.
	Diffuser holes plugged in bottom of container.	Disassemble and clean diffuser holes by flushing water through holes.
Does not dispense full portion.	Out of calibration.	Re-calibrate (See calibration instructions).
Ketchup pattern is irregular.	Holes plugged in bottom of container.	Disassemble and clean holes by flushing water through holes.

PARTS LIST

ITEM	PART NUMBER	DESCRIPTION
1	404-23R	Container
2	404-7	Check Valve Spring
3	404-8	Check Valve
4	404-9	Cylinder
5	404-10	Piston Spring
6	404-11	Piston Slide
7	404-12	Piston
7a	404-15	Piston Valve and Spring Assembly
8	404-6	Push Rod
9	404-4	Adjusting Cam
10	404-3	Lever
10a	404-16	Cam and Lever Assembly
11	404-13S	Tether (pkg. of 6)
12	404-2S	Lid w/Tether (pkg. of 3)

EXPLODED VIEW

